

ARCHITECTURAL SURVEY

SITES IN CAMPECHE

1988 FIELD SEASON

GEORGE F. ANDREWS

UNIVERSITY OF OREGON

STRUCTURE COMPLEX VI Platform in the courtyard

GENERAL DESCRIPTION: Complex VI, which is situated on the north side of the main plaza, consists of a long platform, about 1.25 m. high, which supports three superstructures (U7-1, U8-3, and U9-1). The platform itself measures 7.5 m. long on the south side. The complex is composed of the wall with projecting

CONTENTS

1. EDZNA
 - a. Complex VI (Los Cuchillos)
 - b. Cuchillos Annex
 - c. Structure U8-3 (Casa Grande)
 - d. Structures U9-1 and U9-2 (Templo Sur, Ballcourt, and Casa Sur).
2. KANKI
 - a. Main Group, South Building
 - b. Structure 2
3. XUELEN
 - a. Structure 1
 - b. Structure 2

EXTERIOR DETAILS

BASE BUILDING

Form: Single member rectangular building

Size: 2.5 m. high

Foundation: 3.5 m. at top

LOWER WALL BUILT

Height: 1.25 m. - upper portion 1.25 m.

Structure: Walls faced with plaster, some of the walls, especially wall-out.

Thickness: Exterior walls, wall-out, 1.25 m. thickness.

Decorations: None - walls are plain.

OBSERVATIONS: Material building, open walls, not covered completely from the side.

STRUCTURE: COMPLEX VI (Platforma de los Cuchillos)

GENERAL DESCRIPTION: Complex VI which is situated on the north side of the main plaza, consists of a long platform, about 1.60 m. high, which supports three superstructures (U7-13, U7-14, U7-15). The platform itself measures 70.10 m. long on the south side and 24.47 m. in width at the east end; projecting stairways on all four sides, each with a different form and size, give access to the buildings on the upper level (see plan). The sides of the platform are vertical, and are faced with small to medium sized blocks, similar to those used in the walls of the superstructures. Details of the individual superstructures are given below.

STRUCTURE U7-13

GENERAL DESCRIPTION: Six room building with two parallel rows of three rooms each, situated near west end of main platform. The main facade faces west and a broad stairway on this side gives access to an irregular shaped plaza (Cuchillos annex) with the remains of several buildings, platforms, and stairways along its edges. The rooms on the east side open onto secondary platforms and there is a low wall at right angles to the east facade between the doorways to rooms 2 and 4 with a low platform on the south side (see plan). The exterior walls and vaults have mostly collapsed but one or two courses of the vault are still in place over the central dividing wall.

EXTERIOR DETAILS:**BASE MOLDING:**

Form: Single member rectangular molding.

Size: .20 m. high.

Projection: .03 m. at top.

LOWER WALL ZONE:

Height: Unknown - upper portion fallen.

Stonework: Walls faced with medium sized, rectangular blocks, moderately well-cut.

Thickness: Exterior walls, west side, .78 m. thick average.

Decoration: None - walls are plain.

OBSERVATIONS: Medial molding, upper walls, and cornice completely fallen. No data.

ARCHITECTURAL STYLE: Uncertain. With no details available from medial moldings, upper wall zones or cornice moldings, it is difficult to make a stylistic assessment. The stonework in the lower walls falls somewhere between that seen in classic Chenes and classic Puuc buildings elsewhere, and is similar to the stonework in the outer rooms of the Cinco Pisos pyramid. The large benches are reminiscent of those found in both Chenes and Rio Bec style buildings but benches of this kind are rarely found in classic Puuc style buildings. For the moment, I am inclined to classify this building as a special Edzna version of the Chenes-Puuc style, pending additional architectural data.

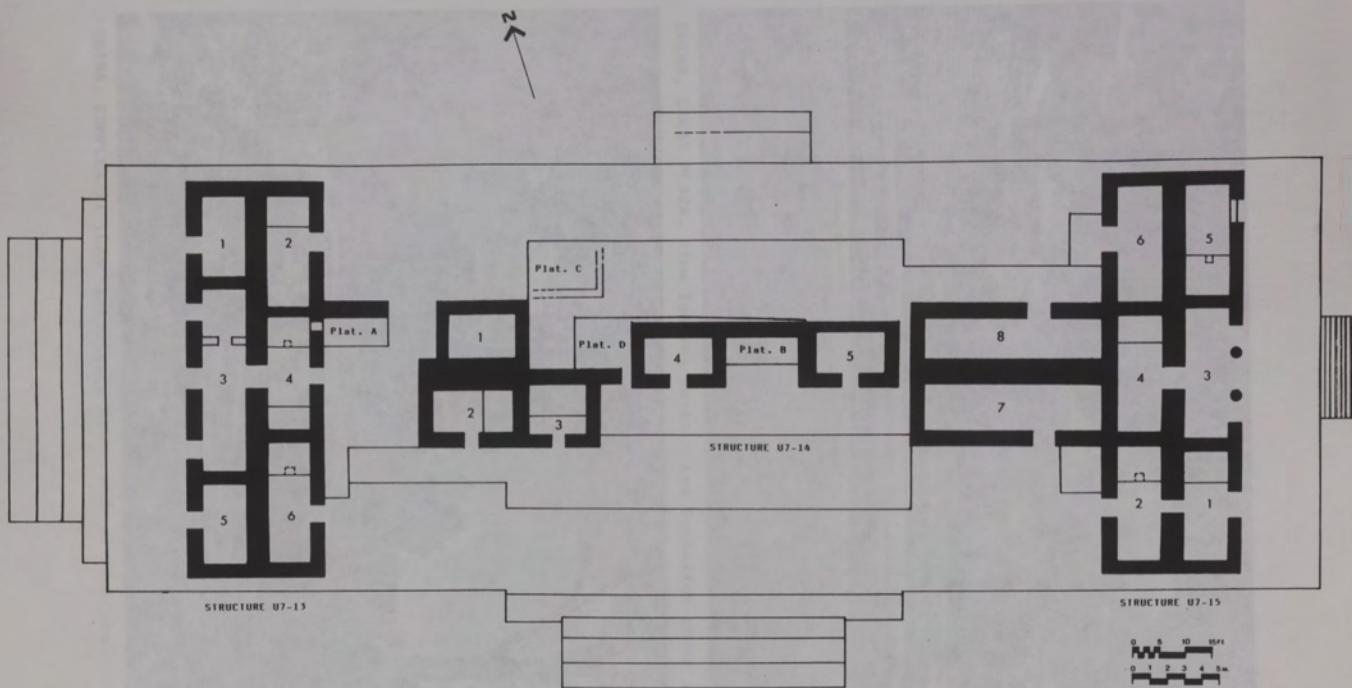

EDZNA
COMPLEX VI - Plan
Los Cuchillos Group
G.F. Andrews, 1988



EDZNA, GREAT PLAZA. View looking north - Los Cuchillos group in background.



EDZNA, COMPLEX VI (Los Cuchillos). South side of platform.



EDZNA, COMPLEX VI. Detail of bench in Structure U8-13.



EDZNA, GREAT PLAZA. View of Main Acropolis (Cinco Pisos) from Complex VI

SITE: EDZNA

NUMBER:

DATE: 2/15/1987

STRUCTURE: U7-13, COMPLEX VI

INTERIOR DETAILS: ROOM 1

DIMENSIONS:

Length: 4.74 m.

Width: 2.51 m. at jamb.

WALLS:

Height: 1.92 m. floor to springline.

Thickness: Front wall .78 m. thick.

Stonework: Walls faced with 8 courses of moderately well-cut, squarish blocks.

Doorways: Exterior doorway 1.11 m. wide.

Rod Sockets: None.

Cordholders: None.

Rings: None.

Wall Openings: None.

Platforms: None.

Other: End wall and front wall mostly fallen.

VAULTS:

Springline Offset: .07 m. Offset in end wall .07 m.

Height: Unknown. Only two courses of vault stones in place.

Form: Uncertain. Mostly fallen.

Stonework: Vaults faced with wedge-shaped stones with beveled faces.

Capstones: No data - fallen.

Crossbeams: Single crossbeams near ends of room in second course of stones below springline.

Other: Vault mostly fallen. Little data available.

OBSERVATIONS: Simple, rectangular room with no special features.

SITE: EDZNA

NUMBER:

DATE: 2/11/1988

STRUCTURE: U7-13, COMPLEX VI

INTERIOR DETAILS: ROOM 2

DIMENSIONS:

Length: 6.61 m.

Width: 2.55 m.

WALLS:

Height: 2.17 m. floor to springline.

Thickness: Exterior wall .78 m. thick at doorjamb.

Stonework: Walls faced with small, moderately well-cut squarish blocks. 9 courses floor to springline.

Doorways: Exterior doorway 1.16 m. wide. Jambs faced with small blocks, somewhat larger than those in wall facings.

Rodsockets: No data.

Cordholders: No data.

Rings: None.

Wall Openings: None.

Platforms: Bench in north end of room 1.73 m. deep, .33 m. high. Plain face.

VAULTS:

Springline Offset: .06 m.

Height: Unknown - mostly fallen.

Form: Vault faces appear to have had straight sides.

Stonework: Vault faced with rectangular slabs - exposed face cut to slope of vault.

Capstones: No data - fallen.

Crossbeams: Single crossbeams near ends of room, just below springline.

OBSERVATIONS: Very similar to Room 6 at south end.

SITE: EDZNA

NUMBER:

DATE: 2/15/1987

STRUCTURE: U7-13, COMPLEX VI

INTERIOR DETAILS: ROOM 3

DIMENSIONS:

Length: 10.74 m.

Width: 2.59 m. at central doorway.

WALLS:

Height: 2.23 m. floor to springline.

Thickness: Front wall .81 m. at jamb.

Stonework: Walls faced with squarish blocks, moderately well-cut and set in fairly even courses. 9 courses floor to springline.

Doorways: Central doorway 1.32 m. wide. Lateral doorways 1.13 m. wide.

Rod Sockets: None visible.

Cordholders: No data.

Rings: No data.

Wall Openings: None.

Platforms: None.

Other: Remains of low wall, about .46 m. thick, between north doorway and central doorway. Doorway centered in this wall - .67 m. wide. This wall added at a later date.

VAULTS:

Springline Offset: .07 m. long walls and end walls.

Height: Unknown. Only two courses of vault stones in place.

Form: Uncertain.

Stonework: Vaults faced with slab to wedge-shaped stones with beveled faces. Moderately well-cut.

Capstones: No data - fallen.

Crossbeams: Single crossbeams near ends of room in first course of stone below springline - .27 m. to center from end walls.

Other: Vault mostly fallen.

OBSERVATIONS: This room has three exterior doorways, while all other rooms have only one.

SITE: EDZNA

NUMBER:

DATE: 2/11/1988

STRUCTURE: U7-13, COMPLEX VI

INTERIOR DETAILS: ROOM 4

DIMENSIONS:

Length: 6.67 m.

Width: 2.51 m.

WALLS:

Height: 2.07 m. floor to springline.

Thickness: Front wall .84 m. thick at doorjamb.

Stonework: Walls faced with small, moderately well-cut blocks with squarish faces. 8 courses floor to springline.

Doorways: Exterior doorway 1.09 m. wide. Floor raised about .23 m. above platform to east.

Rodsockets: No data.

Cordholders: None.

Wall Openings: None.

Platforms: Low platform in south end of room - 1.39 m. deep, .20 m. high. Bench at north end of room 1.83 m. deep, .48 m. high. Niche in front of bench .37 m. wide, .17 m. high, .38 m. deep.

Other: Exterior wall and vault entirely collapsed. Doorway in dividing wall to Room 3 - 1.46 m. wide. Dividing wall is 1.22 m. thick. Floor of this room is about .25 m. above floor in Room 3.

VAULTS:

Springline Offset: .06 m.

Height: Unknown - only two courses in place.

Form: Appears to have had straight sides.

Stonework: Vault faced with moderately well-cut slabs. Exposed face cut to slope of vault.

Capstones: No data.

Crossbeams: Single crossbeams near ends of room, just below springline.

OBSERVATIONS: Note that doorway in dividing wall is wider than exterior doorway. Narrow doorway, .58 m. wide, in north end of room which was later filled in. Doorway led to platform to east.

SITE: EDZNA

NUMBER:

DATE: 2/15/1987

STRUCTURE: U7-13, COMPLEX VI

INTERIOR DETAILS: ROOM 5

DIMENSIONS:

Length: 4.81 m.

Width: 2.55 m. at doorjamb.

WALLS:

Height: 2.25 m. floor to springline.

Thickness: Front wall .79 m. thick at jamb.

Stonework: Walls faced with squarish blocks, .25-.30 m. on face and .15-.20 m. deep. Moderately well-cut.

Doorways: Exterior doorway 1.09 m. wide.

Rod Sockets: None.

Cordholders: None.

Rings: None.

Wall Openings: None.

Platforms: None.

Other: Front wall and south wall mostly fallen.

VAULTS:

Springline Offset: .07 m. long walls and end walls.

Height: Unknown - mostly fallen.

Form: Straight or slightly curved sides.

Stonework: Vaults faced with wedge-shaped stones with beveled faces, moderately well-cut.

Capstones: No data - fallen.

Crossbeams: Single crossbeams near ends of room in first course of stones below springline.

OBSERVATIONS: All details very similar to those seen in Room 1.

SITE: EDZNA

NUMBER:

DATE: 2/11/1988

STRUCTURE: U7-13, COMPLEX VI

INTERIOR DETAILS: ROOM 6

DIMENSIONS:

Length: 7.12 m.

Width: 2.48 m.

WALLS:

Height: 2.0 m. floor to springline.

Thickness: Exterior wall .68 m. thick at doorjamb.

Stonework: Walls faced with small, moderately well-cut squarish blocks; slight variation in size. 8 1/2 courses floor to springline.

Doorways: Exterior doorway 1.05 m. wide. Jambs faced with small blocks similar to those used in wall facings.

Rod Sockets: No data - jambs mostly fallen.

Cordholders: No data.

Rings: None.

Wall Openings: None visible.

Platforms: Large bench in north end of room - .70 m. high, 1.85 m. deep. 3-member molding at top with projecting central member. Overall height 3 members is .50 m. Central member is .14 m. high. Niche in lower portion of face of bench; overall width .63 m., depth .44 m. Partly rounded colonnettes both sides with .24 m. opening in center.

VAULTS:

Springline Offset: .07 m.

Height: Unknown - only two courses in place.

Form: Appears to have had straight sides.

Stonework: Vaults faced with moderately well-cut slabs with face roughly cut to slope of vault.

Capstones: No data - fallen.

Crossbeams: No data.

Other: Upper portion of walls in vault collapsed.

OBSERVATIONS: Large bench in north end of room is reminiscent of large benches seen in many Rio Bec buildings.

SITE: EDZNA

NUMBER:

DATE: 2/11/1988

STRUCTURE: U7-14, COMPLEX VI

GENERAL DESCRIPTION: "Building" of irregular form which consists of a series of small rooms and platforms occupying central portion of Complex VI. Only lower portions of walls are still standing and there is some question as to whether any or all of the rooms had masonry vaults. My earlier notes (Andrews, 1969) say that we found a few vault stones in debris but the lack of debris suggested that rooms were not vaulted. Apparently the recent excavations did little to clarify this question. The rooms face south, overlooking the Main Plaza.

INTERIOR DETAILS:

ROOM 1

Length: 4.0 m.

Width: 2.68 m.

Walls: West wall .63 m. thick, north wall .76 m. and dividing wall to Room 2 is 1.83 m. thick.

Observations: No doorway of any kind visible.

ROOM 2

Length: 4.79 m.

Width: 2.65 m.

Walls: South wall is .81 m. thick.

Doorway: .73 m. wide.

Platforms: Bench, or platform, in east end of room. Bench is 1.85 m. deep and .33 m. high.

Other: Walls stand only to height of about .90 m.

ROOM 3

Length: 3.40 m.

Width: 2.93 m.

Walls: Exterior wall, south side, .71 m. thick.

Doorway: .73 m. wide.

Platforms: Low platform against back wall, 1.83 m. deep and .25 m. high, runs full length of room.

Other: Small banded colonnette in face of bench near left end.

ROOM 4

Length: 4.10 m.

Width: 2.60 m.

Walls: South wall .78 m. thick, rear wall .71 m. thick.

Doorway: 1.06 m. wide.

Other: Walls standing only to height of .60 m.

ROOM 5

Length: 3.99 m.

Width: 2.50 m. at doorjamb.

Walls: South wall .78 m. thick, east wall .68 m. thick.

Other: Decorated stone in east end wall just above floor.

PLATFORM A:

Length: 3.77 m.

Width: 1.80 m.

Height: .31 m.

PLATFORM B:

Length: 4.19 m.

Width: 1.62 m.

Height: .31 m.

PLATFORM C:

Length: 2.56 m.

Width: 3.27 m.

Height: Uncertain (About .46 m.)

Other: Low walls on north and east sides of platform.

PLATFORM D:

Length: 3.34 m.

Width: 3.39 m.

Height: .23 m.

OBSERVATIONS: It is difficult to make any assessment of this group of rooms and platforms as their organization is atypical in terms of conventional "buildings". The rooms may have carried thatched roofs but there is no real evidence for this.

ARCHITECTURAL STYLE: With almost nothing to go on, no stylistic analysis is possible.

SITE: EDZNA

NUMBER:

DATE: 2/23/1988

STRUCTURE: U7-15, COMPLEX VI

GENERAL DESCRIPTION: Good sized building with 8 rooms which is situated near east end of main platform of Complex VI. Building has T-shape, with two rows of rooms running north-south and two rooms behind running east-west (see plan). Main facade faces east and central doorway on this side features two large round columns. Some walls standing nearly to height of springline but vaults, medial molding, upper walls and cornice have completely fallen. What little architectural data is available is given below.

EXTERIOR DETAILS:

BASE MOLDING:

Form: Single member, rectangular molding.

Size: .40 m. high.

Projection: .037 m. projection at top.

LOWER WALL ZONE:

Height: Unknown - upper portions fallen.

Stonework: Walls faced with small blocks, moderately well-cut. Laid in relatively even courses.

Thickness: Exterior walls about .76 m. thick.

Decoration: None - walls are plain.

DOORWAYS:

Shape: Rectangular. Doorway to Room 3 has two round columns.

Jambs: Faced with small blocks, similar to those used in wall facings.

Lintels: No data - fallen.

OBSERVATIONS: No data on medial molding, upper wall zone, or cornice, all of which are now completely fallen.

ARCHITECTURAL STYLE: As is the case with Structure U7-13, the remaining portions of this building offer few clues in regard to architectural style. The round doorway columns are similar to those seen in several rooms of the Cinco Pisos pyramid and the large benches are similar to those seen in Structure U7-13. I would guess that Structure U7-15 is contemporary with Structure U7-13 and that both could be called Chenes-Puuc in style.

INTERIOR DETAILS:

ROOM 1

Length: 6.54 m.

Width: 2.69 m.

Exterior Wall: .76 m. thick. Dividing wall to Room 2 is 1.34 m. thick.

Doorways: Exterior doorway 1.64 m. wide.

Platforms: Bench in north end of room is 1.83 m. deep, .40 m. high.

Projecting molding at top is .15 m. high.

ROOM 2

Length: 6.73 m.

Width: 2.70 m.

WALLS:

Thickness: Exterior wall is .76 m. thick. Dividing wall to Room 1 is 1.34 m. thick.

Doorways: Exterior doorway 1.11 m. wide. Doorway in dividing wall to Room 2 is .77 m. wide.

Platforms: Bench in north end of room is 2.03 m. deep, .66 m. high. Molding at upper edge is .17 m. high, molding at bottom .20 m. high. Niche in center of central member with colonnettes on both sides.

ROOM 3

Length: 7.65 m.

Width: 2.73 m.

Walls: Exterior wall .76 m. thick. Dividing wall to Room 4 is 1.27 m. thick.

Doorways: Exterior doorway with two round columns is 5.87 m. wide overall. Columns 2.55 m. center to center.

ROOM 4

Length: 6.85 m.

Width: 2.71 m.

Doorways: Doorway in dividing wall to Room 3 is 1.43 m. wide.

Platforms: Platform in north end of room is 1.62 m. deep, .23 m. high.

ROOM 5

Length: 6.52 m.

Width: 2.71 m.

Walls: Exterior wall is .78 m. thick.

Doorways: Exterior doorway is 1.34 m. wide. Step up at sill.

Platforms: Bench in south end of room is 2.36 m. deep, .63 m. high. Molding at top .12 m. high. Niche in center is .50 m. wide, .37 m. high, .23 m. deep.

ROOM 6

Length: About 6.52 m. (north end wall fallen)

Width: 2.69 m.

Doorways: Exterior doorway, west side, 1.57 m. wide.

ROOM 7

Length: 10.34 m.

Width: 2.73 m.

Walls: Exterior wall, south .91 m. thick.

ROOM 8

Length: 10.36 m.

Width: 2.41 m.

Walls: Dividing wall to Room 7 is 1.83 m. thick.

STRUCTURE U7-10

STRUCTURE U7-7

2

P L A Z A

STRUCTURE U7-12

STRUCTURE U7-13

STRUCTURE U7-11

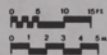

EDZNA
Cuchillos Annex - Plan
G.F. Andrews, 1988



EDZNA, CUCHILLOS ANNEX. View of plaza looking west.



EDZNA, CUCHILLOS ANNEX. View of plaza looking northwest.

SITE: EDZNA

NUMBER:

DATE: 3/1/1987

STRUCTURE: U8-3 (Nahol Na, Casa Grande, Palace)

GENERAL DESCRIPTION: Structure U8-3, which is situated on the west side of the Great Plaza, is a long, stepped platform with two gallery-type buildings on top. The main axis of both substructure and superstructure is 10 degrees (magnetic) east of north. A very broad stairway on the east side leads from the plaza level to the top of the main platform, which is about 6.50 m. high. Over the past two seasons (1987-88) the eastern portion of this structure was excavated and consolidated, revealing many additional details, particularly in regard to the eastern stairway which previously had been obscured by debris.

SUBSTRUCTURE (Stepped Platform)

The substructure of Structure U8-3, which measures about 128.5 m. in length overall, appears to have had stepped sides although most of its outer surfaces have been stripped off and its profile is uncertain. The north end of the platform is particularly confusing since the recent excavations have revealed a number of angular walls whose larger form is not clear (see plan). Most of the east side of the platform is taken up with a monumental stairway, about 113 m. long, which has 13 treads; at the plaza level, and roughly centered, is an additional projecting step about 12.5 m. wide and .86 m. deep. At the top of the main platform, directly in front of the central passageway between the two superstructures, is a projecting platform about 6.0 m. wide. This secondary platform might be interpreted as a kind of "speaker's platform" or "stage", providing a prominent position for anyone wishing to address a crowd gathered in the Great Plaza below.

SUPERSTRUCTURE: (Buildings on Upper Level)

The superstructure of U8-3 consists of two long gallery-type buildings, separated by a narrow passageway running east-west (see plan). Each of these buildings has two parallel galleries running north-south, separated by a thick medial wall, with doorways opening to both the east and west. Only small portions of the western galleries have been excavated but the eastern galleries have been cleared of debris and the remaining portions of walls and piers consolidated. There are no openings in the dividing wall between the east and west galleries of the south wing but a narrow passageway in the dividing wall of the north wing does provide direct access from the eastern gallery to the western gallery. The eastern galleries of both wings have 12 doorways, with wide piers between, opening toward the great Plaza and from what can presently be seen, the western galleries had a similar number of doorways.

The recent excavations yielded nothing to indicate that the galleries were covered over by masonry vaults and it seems likely that they had pole-and-thatch roofs, which have left no trace of their former presence.

DIMENSIONS:

EAST GALLERY, SOUTH WING

Length: About 54.6 m.

Width: About 1.76 m. (varies).

Doorways: 12 doorways, varying in width from .75 m. to 2.10 m.

Walls: Front walls 1.0 m. thick. Dividing wall 2.18 m. thick.

CENTRAL PASSAGEWAY

Length: About 6.7 m.

Width: 2.71 m.

Height: Unknown.

EAST GALLERY, NORTH WING

Length: About 55.0 m.

Width: About 1.90 m. (varies).

Walls: Front walls .96 m. thick. Dividing wall 2.21 m. thick.

Doorways: 12 doorways in front (east) wall ranging in width from 1.66 m. to 2.04 m. Doorway in dividing wall, 1.22 m. wide.

OBSERVATIONS: Both galleries stand on a low base, .30 m. high, which projects out .20 m. in front of eastern walls. Terrace in front of both galleries is 1.37 m. wide and runs full length of both buildings.

ARCHITECTURAL STYLE: Uncertain. With so little to go on, it is almost impossible to classify Structure U8-3 in terms of style. The rather crude stonework, lack of masonry vaults, and narrow gallery spaces all suggest an Early Classic construction date for both substructure and superstructures but most of the basic stylistic features are missing.

→ 2

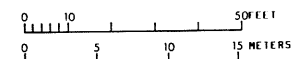
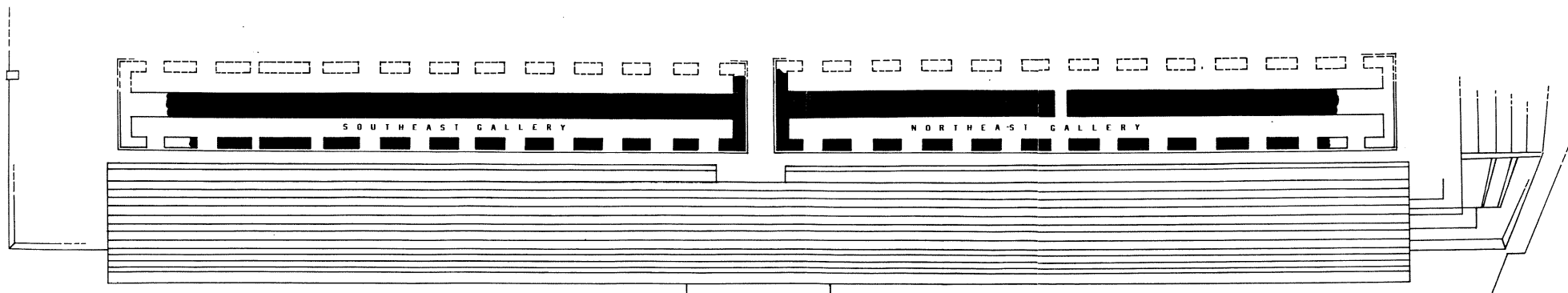

EDZNA
Structure UB-3 (Naholna)
Plan
G.F. Andrews, 1988

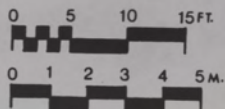
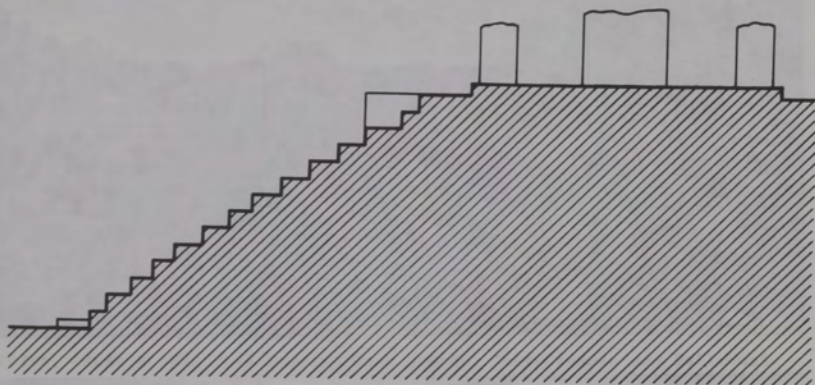

EDZNA
Structure U8-3 (Naholna)
Section - looking South
G.F. Andrews, 1988



EDZNA, GREAT PLAZA. View showing Casa grande, South temple and Ballcourt.



EDZNA, SOUTH TEMPLE AND BALLCOURT. View looking south.



EDZNA, Ballcourt. View looking south.



EDZNA, Ballcourt. Detail of west side showing remains of large ring.



EDZNA, Ballcourt and South temple. Stairway at north end of Ballcourt.



EDZNA, South temple. View looking northwest.

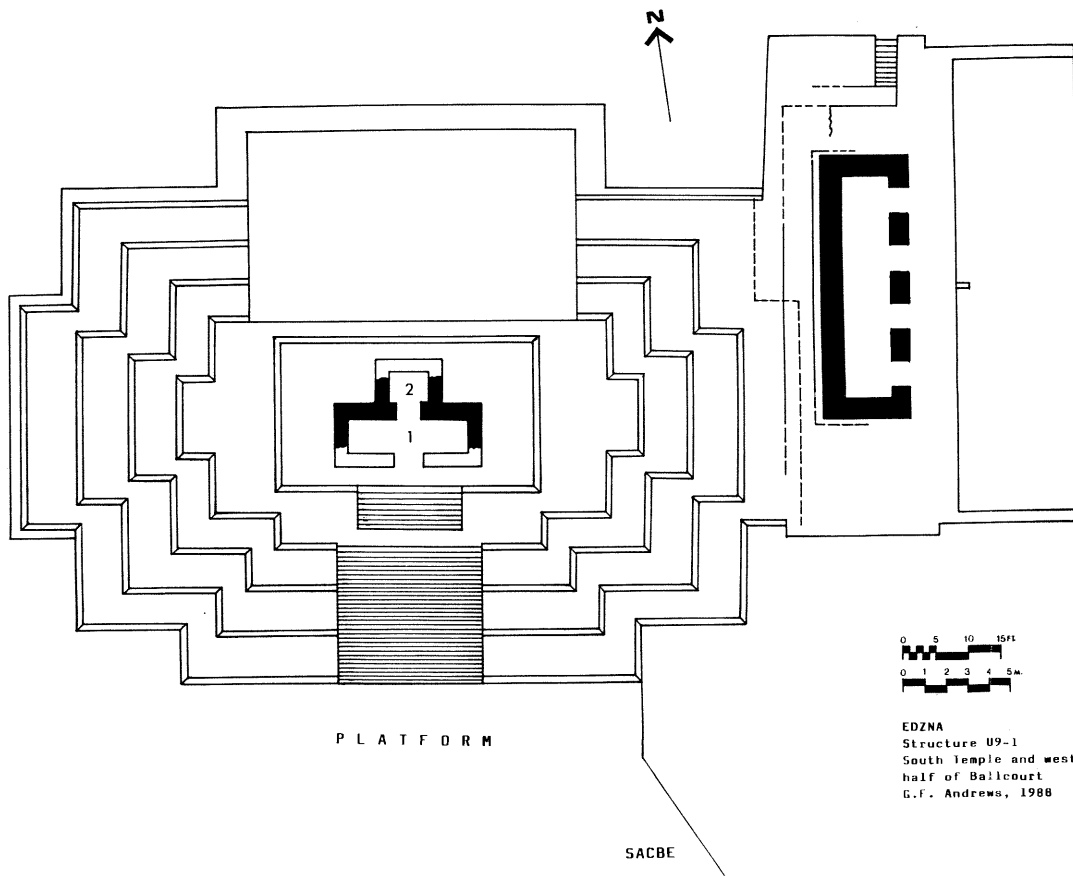

EDZNA
Structure U9-1
South temple and western
half of Ballcourt
G.F. Andrews, 1988

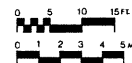
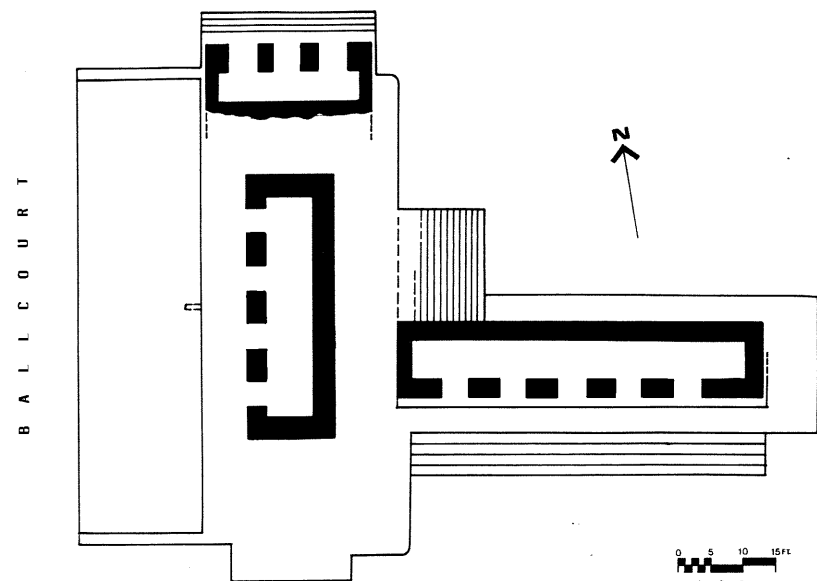

EDZNA
Structure U9-2
Casa Sur and Eastern
half of Ballcourt
G.F. Andrews, 1988



EDZNA. Stela #



EDZNA. Stela #



EDZNA. Stela #



EDZNA. Stela #



EDZNA. Detail of inscription, Stela #

SITE: KAMEI

WISCONSIN

DATE: 1960-10-10

BACKGROUND: I have no information on this site prior to 1940 (possibly by Pollock) and no information on the site prior to 1940 and on the site prior to 1940. Pollock (1940) includes a fairly comprehensive description of the site and its architectural remains. In the course of the summer field work and the site was found to be a complex of several structures and lower levelled areas. (See Pollock's report, 1940). I visited the site in March of 1960, accompanied by my wife and assistant, Geraldine Andrews, and secured material from the site.

SITUATION: The site is situated a short distance from the old railroad track (now a modern highway), which passes at about 100 m. south-west of the site. As noted by Pollock (1940) it is in the same vicinity as sites such as Kamea, Kamea, Kamea, and Kamea, which are no more than 7-8 km. away.

TOPOGRAPHY: The terrain is generally hilly in the vicinity of the site, with savanna between the hills. The site itself appears to be on a group of adjacent hills, with savanna to the east and west. Pollock mentions outlying groups on floor of savanna.

WATER SUPPLY: According to Pollock, there is a large spring in savanna east-northeast of South Group. Numerous channels in terraces associated with various building groups.

WATER: None. Site was very overgrown at the time of my visit, which made it impossible to attempt even a rough map.

SIZE: Appears to be a good sized site as Pollock describes several groups of structures spread over a considerable area, including two pyramids. As in the case with so many other sites, it is difficult to determine the site limits, due to the "disorganized" organization.

SITE: KANKI

NUMBER:

DATE: 3/8/1988

BACKGROUND: I have no information on initial discovery of Kanki (possibly by Pollock) but it is shown on the old Tulane map of the Maya area (1940) and on the old Archaeological Map of Campeche (Muller, 1960). Pollock (1982) included a fairly comprehensive discussion of the site and its architectural remains in his review of the western Puuc sites and the site was more recently investigated by Antonio Benavides and Renee Lorelei Zapata, Centro Regional de Campeche, INAH (1986). I visited the site in March of 1988, accompanied by my wife and assistant, Geraldine Andrews, and several natives from the nearby ejido.

SITUATION: The site is situated a short distance from the old hacienda Kanki (now a modern ejido), which places it about 12-13 km. southeast of Tenabo. As noted by Pollock (1982:523) it is in the same vicinity as sites such as Xcocha, Xtampak, Bolonchoch, and Xcorralcot, which are no more than 7-8 km. away.

TOPOGRAPHY: The terrain is generally hilly in the vicinity of the site, with savannas between the hills. The site center appears to be on a group of adjacent hills, with savannas to the east and west. Pollock mentions outlying groups on floor of savannas.

WATER SUPPLY: According to Pollock, there is a large aguada in savanna east-northeast of South Group. Numerous chultuns in terraces associated with various building groups.

MAPS: None. Site was very overgrown at the time of my visit, which made it impossible to attempt even a sketch map.

SIZE: Appears to be a good sized site as Pollock describes several groups of structures spread over a considerable area, including two pyramids. As is the case with so many Puuc sites, it is difficult to determine the site limits, due to the "dispersed" organization.

SITE: KANKI

NUMBER:

DATE: 3/8/1988

CIVIC PLAN: Pollock, who saw more of the site than we did, notes that "center" of site is marked by tightly packed aggregate of adjacent courts, terraces, and buildings and this corresponds to my own impression. He also suggests that the two facing pyramids in the South and West groups might indicate an effort to establish a larger axial organization.

COMMENTS: Pollock's earlier report (1982:523-530) is much more complete than mine since we were able to spend only a few hours at the site. Nevertheless, we were impressed with the size of the building remains, and the numerous doorway columns and other large lintel and jamb stones scattered throughout the debris from fallen buildings.

Observations: Wall faced with wall, composed of large and small stones.

Dimensions: Wall - 1.0 m. high, 0.5 m. wide.

Remarks: None.

WALLS:

Observations: Wall - very slight inward curve.

Dimensions: Wall - 1.0 m. high, 0.5 m. wide.

Remarks: Stone lintel - 1.17 m. high.

WALL REMAINS:

Observations: Two remains. Rectangular lower corner formed with the corner of stone. Narrow, projecting rectangular corner stone. Lower corner about .20 m. high.

UPPER WALL, 2001:

Observations: Unknown. Upper portion completely fallen.

Dimensions: None in place.

Remarks: Upper wall faced with wall blocks similar to those in lower walls.

CORNER: No more. Fallen.

SITE: KANKI

NUMBER:

DATE: 3/8/1988

STRUCTURE: South Building, Main Group.

GENERAL DESCRIPTION: Four-room building; two central rooms with lateral rooms at ends.

EXTERIOR DETAILS: Details are for north facade.

ORIENTATION: Main facade faces north.

BASE MOLDING: No data - completely covered with debris. (Pollock recorded single member rectangular base molding with .05 m. projection).

LOWER WALL ZONE:

Height: Unknown. Lower portion covered with debris.

Stonework: Walls faced with small, squarish blocks, moderately well cut.

Thickness: Front wall = .69 m. thick at doorjamb.

Decoration: None.

DOORWAYS:

Shape: Jambs show very slight inward shape.

Jambs: Faced with small blocks, similar to those used in wall facings.

Lintels: Stone lintel = .17 m. thick.

MEDIAL MOLDING:

Form: Two members. Rectangular lower member formed with two courses of stones. Narrow, projecting rectangular member above. Lower member about .80 m. high.

UPPER WALL ZONE:

Height: Unknown. Upper portion completely fallen.

Decoration: None in place.

Stonework: Upper wall faced with small blocks similar to those in lower walls.

CORNICE: No data. Fallen.

SITE: KANKI

NUMBER:

DATE: 3/8/1988

ROOF STRUCTURE: Remains of roofcomb, now fallen, over dividing wall between central rooms. No data.

ARCHITECTURAL STYLE: Proto-Puuc style.

OBSERVATIONS: Small building with typical plan for Proto-Puuc style.



○ COL. ALTAR

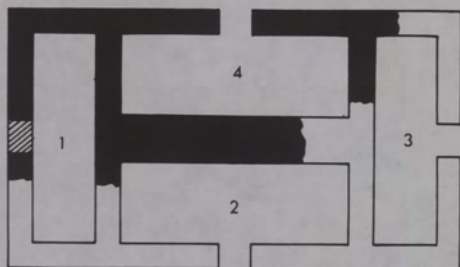

PLAN

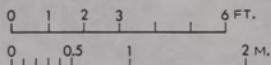
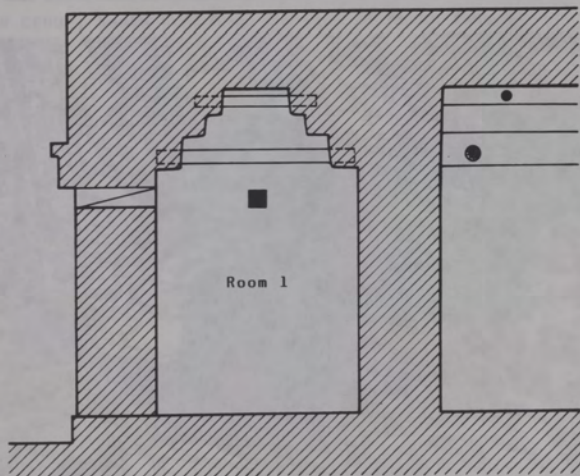
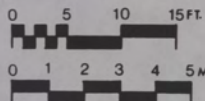

KANKI
Main Group, South Bldg.
Section - Room 1
G.F. Andrews, 1988

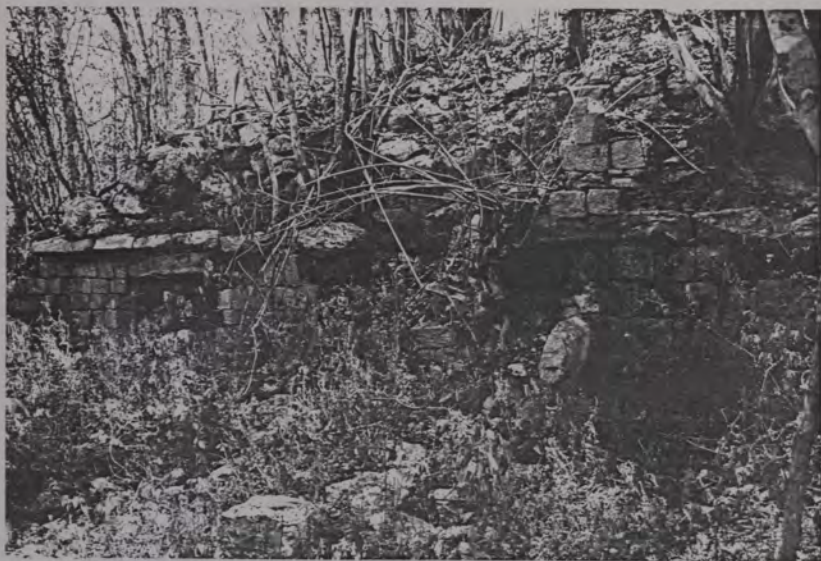

KANKI, MAIN GROUP, South Building. Portion of north facade.



KANKI, MAIN GROUP, South Building. Detail of stepped vault, Room 1.

SITE: KANKI

NUMBER:

DATE: 3/8/1988

STRUCTURE: South Building, Main Group

INTERIOR DETAILS: ROOM 1

DIMENSIONS:

Length: Uncertain. End wall fallen (approximately 6.38 m.)

Width: 1.73 m.

WALLS:

Height: 2.09 m. floor to springline.

Thickness: Uncertain.

Stonework: Walls faced with small blocks about .15 - .17 m. high. Faces of blocks moderately well finished.

Doorways: Doorway in west end wall, .84 m. wide, later filled in. .33 m. bottom of lintel to springline.

Rod Sockets: No data.

Cordholders: No data.

Wall Openings: Small square hole, .15 x .15 m. in north end wall in second course below springline.

Platforms: No data.

Other: South end of room collapsed.

VAULTS:

Springline Offset: .22 - .25 m.

Height: .67 m. springline to bottom of capstones.

Form: Stepped vault with 3 steps. Projection at springline .21 m. Vertical .27 m. Step .21 m. Vertical .16 m. Step .14 m. Vertical .20 m.

Stonework: Vaults faced with very roughly dressed slabs - much chinking between courses.

Capstones: Span = .33 m.

Crossbeams: Single crossbeams near end of room just above springline. Additional crossbeams in center of uppermost step of vault.

Other: No offset in end wall at springline. End wall is vertical.

SITE: KANKI

NUMBER:

DATE: 3/8/1988

OBSERVATIONS: All rooms have stepped vaults. Rooms 2, 3, 4 mostly fallen. Remaining details similar to those seen in Room 1. See Pollock (1982:526-27) for additional details of this building.

a projecting stairway, but only part of the wall between them are now exposed. Upper level rooms now collapsed and only a small portion of east facade now exposed. This facade carries fragments of large walls just above base molding. I believe this may be the building described by Pollock as near the eastern edge of the West Group (1982:526) but cannot be sure of this.

EXTERIOR DETAILS: Details above and on east facade of rooms on lower level.

ORIENTATION: 125 degrees (approximate), perpendicular to east facade.

BASE MOLDING: no data - covered with debris.

LOWER WALLS: no data - covered with debris.

PASSAGES:

Chapel: Doorway of room adjacent to stairway has multiple entrance, formed by two round columns with square capitals.

Door: Faced with small blocks, similar to those normally used on wall facades.

Lintel: Stone lintels. Space between column capitals = 1.25 m.

MEDIA MOLDING:

Form: Three members. Apron-type lower member with slight inward slope. Central member has small capitals, aligning with plate areas (see photo). Face of upper member has very slight inward slope.

Size: Overall height = .48 m. Upper member .15 m. high. Central member .15 m. high.

Projection: See section.

SITE: KANKI

NUMBER:

DATE: 3/8/1988

STRUCTURE: 2 (Building at eastern edge of Main Group)

GENERAL DESCRIPTION: Badly fallen building with remains of rooms on two levels. Lower level seems to consist of four rooms, two on each side of a projecting stairway, but only portions of the two southern rooms are now exposed. Upper level rooms now collapsed and only a small portion of east facade now exposed. This facade carries remains of large masks just above base molding. I believe that this is the building described by Pollock as near the eastern edge of the Main Group (1982:524) but cannot be sure of this.

EXTERIOR DETAILS: Details below are for east facade of rooms on lower level.

ORIENTATION: 105 degrees (magnetic), perpendicular to east facade.

BASE MOLDING: No data - covered with debris.

LOWER WALLS: No data - covered with debris.

DOORWAYS:

Shape: Doorway of room adjacent to stairway has multiple entrances, formed by two round columns with square capitals.

Jambs: Faced with small blocks, similar to those normally used in wall facings.

Lintels: Stone lintels. Span between column capitals = 1.01 m.

MEDIAL MOLDING:

Form: Three members. Apron-type lower member with slight inward slope. Central member has small recesses, alternating with plain areas (see photo). Face of upper member has very slight inward slope.

Size: Overall height - .48 m. Upper member .16 m. high, central member .15 m. high.

Projection: See section.

UPPER WALL ZONE:

Height: 1.38 m. - top of medial molding to bottom of cornice.

Decoration: Upper wall decorated with large masks, now mostly fallen. Above masks are a series of projecting stones which probably supported other stucco sculptures.

Stonework: Wall faced with small, squarish blocks, only roughly dressed.

CORNICE:

Form: Uncertain - only lowest member still in place, which is rectangular.

Size: .16 m. high.

Projection: .037 m. projection at bottom.

EXTERIOR DETAILS, UPPER LEVEL: Details below are for east facade of room(s) on upper level. This facade set back about 1.8 m. from facade of rooms on lower level.

BASE MOLDING:

Form: Three members. Projecting rectangular members top and bottom, with squarish colonnettes in central member.

Size: Upper member .16 m. high. Colonnettes about .17-.20 m. wide, with .05 m. spaces between.

Other: Traces of red paint in recesses between colonnettes.

LOWER WALL ZONE:

Height: Unknown - upper portion fallen.

Decoration: Remains of large mask forms immediately above base molding. One of these masks is .94 m. wide overall, with mouth .54 m. wide. Projecting nose on this mask is .23 m. wide and .21 m. high. Projects .38 m. Stucco on nose shows traces of red and blue paint.

Other: No other data as wall above is completely fallen.

SITE: KANKI

NUMBER:

DATE: 3/8/1988

INTERIOR DETAILS: Rooms are mostly fallen or filled with debris and no real data available. Exposed portions show classic Puuc forms and stonework.

ARCHITECTURAL STYLE: Uncertain. Facades on both levels differ from those seen on typical Puuc buildings of any style, early or late. Vaults show classic Puuc forms and stonework but doorways with round columns are found in both Early Puuc and Classic Puuc structures. Moldings do not conform to any particular style although they differ considerably from those of the earlier styles. More data required to make an accurate classification.

OBSERVATIONS: I believe that the rooms and facades described above were recently exposed by looters.

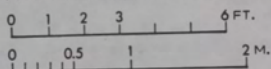
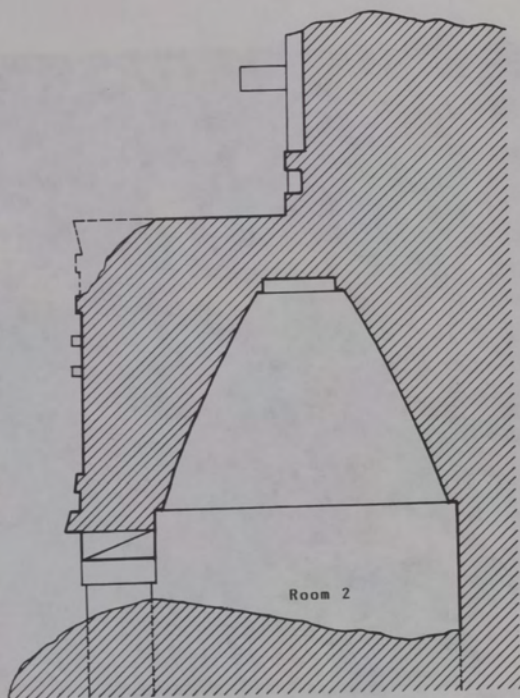

KANKI
Structure 2
Section - Room 2
G.F. Andrews, 1988

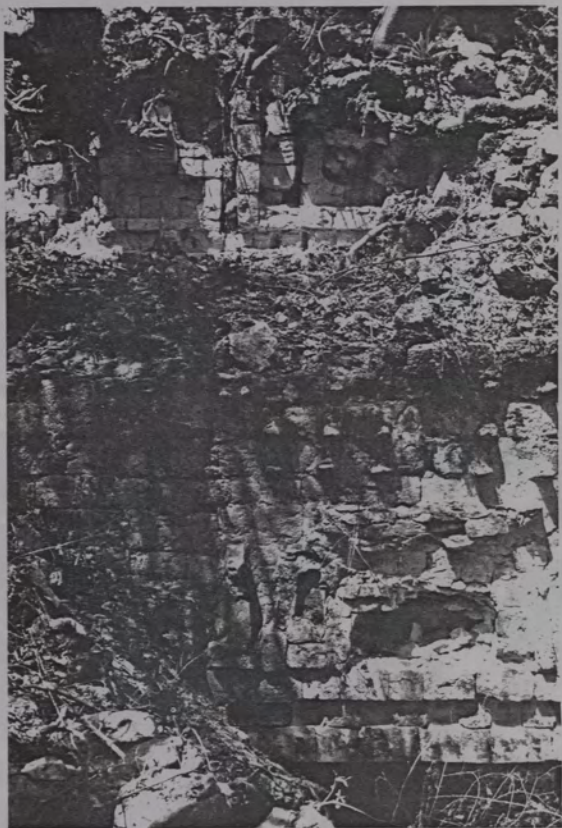

KANKI, Structure 2. Exposed portion of lower and upper facades.



KANKI, Structure 2. Detail of upper facade.



KANKI, Structure 2. Detail of lower facade.

SITE: XUELIN

NUMBER:

DATE: 1/25/1968

BACKGROUND: Site was first reported by William Brundage and Claude Loraine Joplin, Centro Regional de Arqueología, Tuxtla Gutierrez. It is not shown on any of the older archaeological maps or drawings and I know of no other references. I investigated this site in March of 1968, accompanied by my wife and assistant, American natives.

SITUATION: The site is situated about 1 km. west of the modern village of Santa Cruz, on the grounds of the retired National Guard. The ruins are about 400-500 m. northwest of the ranch buildings.

TOPOGRAPHY: The terrain in the vicinity of the site is relatively flat and the ruins stand on a low rise of ground, which has been terraced into several levels.

WATER SUPPLY: No chultens noted, although they may be present. Modern well a mile.

MAPS: None, other than sketch map of each group included with this report.

SIZES: Appears to be a very small site and on ground only a few scattered small mounds and platforms in addition to Structures 1 and 2.

CIVIC PLAN: No real data. Structures 1 and 2 stand on a low terrace which opens to the south.

COMMENTS: While not important site in terms of size, Xuelin is important in terms of settlement studies since it is located in the coastal plain area near the western edge of the high archaeological region. Most of the western Piedra Blanca sites further to the west lie in or west of the hills which run parallel to the old Carretera Real between Tempeche and Tuxtla.

SITE: XUELEN

NUMBER:

DATE: 3/9/1988

BACKGROUND: Site was first reported by Antonio Benavides and Renee Lorelei Zapata, Centro Regional de Campeche, INAH (1986). It is not shown on any of the older archaeological maps of Campeche and I know of no other references. I investigated the site in March of 1988, accompanied by my wife and assistant, Geraldine Andrews.

SITUATION: The site is situated about 5 km. west of the modern village of Santa Cruz, on the grounds of the rancho Xuelen. The ruins are about 400-500 m. northwest of the ranch buildings.

TOPOGRAPHY: The terrain in the vicinity of the site is relatively flat and the ruins stand on a low rise of ground, which has been terraced into several levels.

WATER SUPPLY: No chultuns noted, although they may be present. Modern well a ranch.

MAPS: None, other than sketch map of main group included with this report.

SIZE: Appears to be a very small site and we noted only a few scattered small mounds and platforms in addition to Structures 1 and 2.

CIVIC PLAN: No real data. Structures 1 and 2 stand on a low terrace which opens to the south.

COMMENTS: While not important site in terms of size, Xuelen is important in terms of settlement studies since it is located in the coastal plains area near the western edge of the Puuc archaeological region. Most of the western Puuc sites further to the east lie in or east of the hills which run parallel to the old Camino Real between Campeche and Merida.

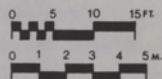
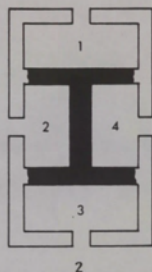

T E R R A C E

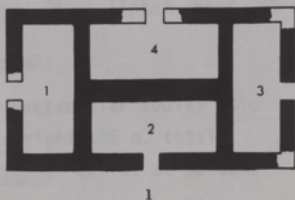

XUELEN
Structures 1 and 2 - Plan
G F Andrews, 1988

SITE: XUELEN

NUMBER:

DATE: 3/9/1988

STRUCTURE: 1

GENERAL DESCRIPTION: Four-room building standing on low terrace. Two central rooms with transverse rooms at ends.

EXTERIOR DETAILS:

ORIENTATION: 205 degrees (magnetic) perpendicular to south facade.

BASE MOLDING: No base molding or small single member base molding now covered with debris.

LOWER WALL ZONE:

Height: 2.17 m. bottom of wall to medial molding.

Stonework: Walls faced with square to rectangular blocks, only roughly dressed. Eight to 9 courses - courses irregular.

Thickness: South wall = .52 m. thick at doorjamb.

Decoration: Considerable orange-reddish paint on south facade.

DOORWAYS:

Shape: Rectangular.

Jambs: Faced with large slabs full thickness of wall.

Lintels: Stone lintel about .20 m. thick.

MEDIAL MOLDING:

Form: Rectangular medial molding formed with two courses of stone.

Size: Height .35 m. total.

Projection: .24 m. at bottom.

UPPER WALL ZONE:

Height: Unknown. Most of upper portion fallen (but at least 1.37 m.).

Decoration: No data. Only one course of stones still in place. Traces of red paint on this section.

Stonework: Wall faced with roughly dressed blocks, similar to those in lower walls.

Other: Upper wall steps back about .10 m. from outer face of medial molding.

SITE: XUELEN

NUMBER:

DATE: 3/9/1988

CORNICE: No data. Fallen.

ROOF STRUCTURE: No data - fallen. Amount of debris on roof suggests former presence of roofcomb.

ARCHITECTURAL STYLE: Tentatively Proto-Puuc. This classification based on crude stonework, heavy medial molding, and seeming lack of base molding.

OBSERVATIONS: Construction and stonework rather crude throughout. Surfaces irregular as is edge of medial molding.

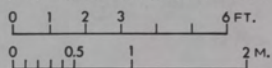
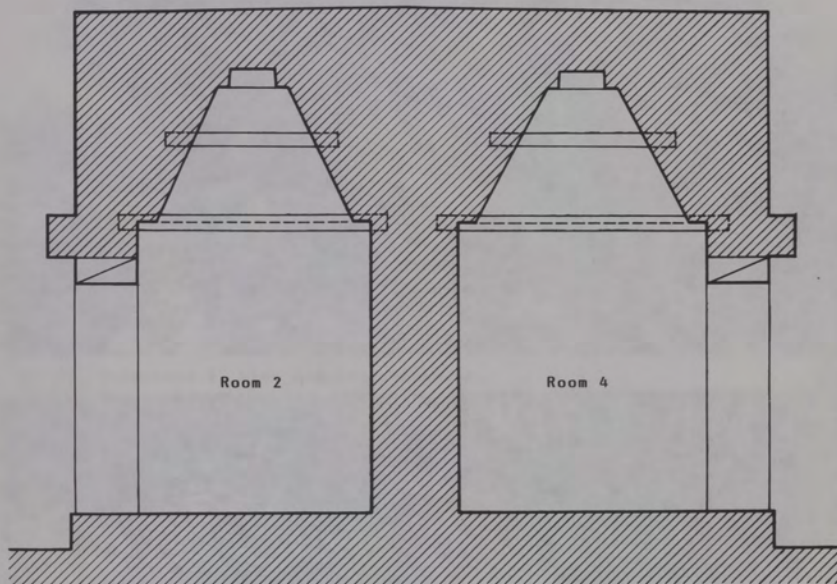

XUELEN
Structure 1
Section, Rooms 2 and 4
G.F. Andrews, 1988



XUELEN, Structure 1. View looking northwest.



XUELEN, Structure 1. Detail of south facade.

FIG. 1. Vault

STRUCTURE 1

INTERIOR DETAIL

VIEW



XUELEN, Structure 1. Detail of vault.

SITE: XUELEN

NUMBER:

DATE: 3/9/1988

STRUCTURE: 1

INTERIOR DETAILS: ROOM 1

DIMENSIONS:

Length: 5.07 m.

Width: 1.98 m. at doorjamb.

WALLS:

Height: 2.26 m. floor to springline.

Thickness: Exterior wall = .56 m. thick at jamb.

Stonework: Walls faced with 9 courses of medium to large blocks, only roughly dressed.

Doorways: Doorway mostly fallen. Stone lintel in place, .23 m. high. .40 m. bottom of lintel to springline.

Rod Sockets: No data. Jambs fallen.

Cordholders: Very large finger type cordholders to south side of doorway. .46 m. to center below springline. .46 m. to center from doorjamb.

Wall Openings: Holes about .16 m. square, in both end walls - .23 m. to top from springline. Additional holes in outside wall - .68 m. to center from end walls.

Platforms: None.

Other: Wall surfaces very irregular due to crude stonework.

VAULTS:

Springline Offset: Varies .16 - .19 m.

Height: 1.06 m. springline to bottom of capstone molding.

Form: Vault faces have straight sides.

Stonework: Vaults faced with 6 courses of slabs - exposed face moderately well finished.

Capstones: Span about .37 m. Very large molding below capstones, .15 - .18 m. high.

SITE: XUELEN

NUMBER:

DATE: 3/9/1988

Crossbeams: Single crossbeams near ends of room just above vault springline. One additional crossbeam near center of room in 2nd course of stones below capstone molding.

Other: Vault surface very irregular due to crude stonework.
Offsets in end walls same as long walls.

OBSERVATIONS: Relatively narrow, crudely constructed room.

SITE: XUELEN

NUMBER:

DATE: 3/9/1988

STRUCTURE: 1

INTERIOR DETAILS: ROOM 2

DIMENSIONS:

Length: 4.59 m.

Width: 1.99 m. at doorjamb.

WALLS:

Height: 2.44 m. floor to springline.

Thickness: Exterior wall = .53 m. thick at jamb. Dividing wall to Room 1 = .58 m. thick.

Stonework: Walls faced with 7-8 courses of squarish blocks varying considerably in size; very roughly dressed.

Doorways: Exterior doorway = .66 m. wide. .52 m. bottom of stone lintel to springline.

Rod Sockets: None.

Cordholders: Post type cordholders both sides of doorway high and low .68 m. to center from jambs. .58 m. to center below springline. 1.55 m. center to center vertically.

Wall Openings: Holes in exterior wall, about .12 m. square. .35 m. to top from springline, .63 m. to center from end walls.

Platforms: None.

Other: Surfaces of walls very irregular due to crude construction and stonework. Looter's hole in east end of room.

VAULTS:

Springline Offset: .15 - .18 m.

Height: 1.14 m. springline to bottom of capstone molding.

Form: Straight sides.

Stonework: Vaults faced with 6 courses of slabs. Outer face moderately well cut.

Capstones: Span about .35 - .40 m. Line very irregular. Note that molding is about .15 m. high with .11 m. offset below.

Crossbeams: Single crossbeams near ends of room centered on springline. One additional crossbeam centered in top of third course below capstone molding.

SITE: XUELEN

NUMBER:

DATE: 3/9/1988

Other: Traces of red and black painting on rear vault. Traces of red paint on capstone molding and bottom of capstones.

OBSERVATIONS: Room well preserved except for deliberate destruction by looters. Vault completely intact.

INTERIOR DETAILS: ROOM 3

Length = 5.07 m. Width = 1.83 m. All details in this room same as in Room 1. Capstone span slightly less. Exterior doorway completely fallen.

INTERIOR DETAILS: ROOM 4

Length = 4.85 m. Width = 2.13 m. Exterior wall completely fallen. All other details same as in Room 2.

SITE: XUELEN

NUMBER:

DATE: 3/9/1988

STRUCTURE: 2

GENERAL DESCRIPTION: Four-room building now badly fallen. Plan similar to that of Structure 1 but rooms are smaller.

EXTERIOR DETAILS: All exterior walls of this building completely collapsed. No data. Assume exterior similar to that of Structure 1 since details of vaults still in place are virtually identical to those in Structure 1.

ORIENTATION: 108 degrees (magnetic), perpendicular to rear wall of east room.

ROOM DIMENSIONS:

East room - Length: 3.16 m. Width: 1.67 m.

South room - Length: 4.31 m. Width: Unknown.

West room - Length: 3.31 m. Width: 1.75 m.

North room - Length: 4.18 m. Width: No data.

ALL ROOMS:

1.04 m. springline to bottom of capstone molding.

Capstone molding = .13 m. high.

Capstone span, East room, .30 m.

Single crossbeams near ends of rooms at springline as in Structure 1.

OBSERVATIONS: Structure 2 stands on a low platform about 1.5 m. high and is oriented at right angles to Structure 1.



XUELEN, Structures 1 and 2. View looking northeast.



XUELEN, Structure 2. South side.

